

3.5-Zimmer-Wohnung 92.9 m² Loggia 9.1 m²

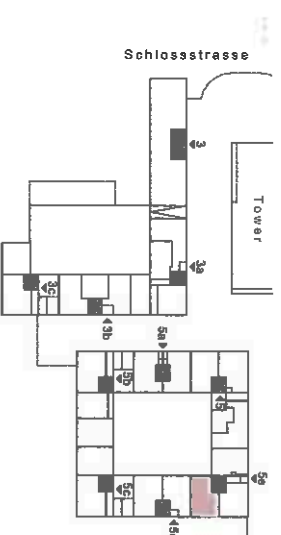

- Schlossstrasse 5e, 4133 Pratteln**
- | | |
|-------|-----------------|
| EG | Whg. Nr. 5e.002 |
| 1. OG | Whg. Nr. 5e.102 |
| 2. OG | Whg. Nr. 5e.202 |
| 3. OG | Whg. Nr. 5e.302 |

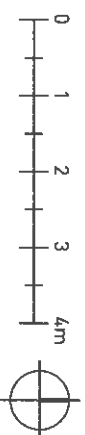

Massstab 1:100
Änderungen vorbehalten.